

Anchor Lås Padlocks

The attack- and tamper-resistant Anchor Lås Padlock pairs a heavy-duty CyberLock cylinder with a hardened steel body, giving organizations the power to extend access control to any location.

PLTX-01KR-DR5



EN12320 Grade 5 Attack Resistant

The padlock body was tested to Grade 5 per EN12320:2012.



Increased Accountability

A time stamped access event is recorded in both the lock and the key.



On-the-Go Access

Quickly schedule and review access with the powerful CyberLock management software, CyberAudit®-Web.



- Paired with our CLTX-PL5WRD cylinder, the Anchor Lås padlock can be used for everything from storage room lockers to the most remote utility stations.
- Designed to withstand harsh outdoor environments, the Anchor Lås padlock was tested to the highest corrosion resistance under EN16864:2017.

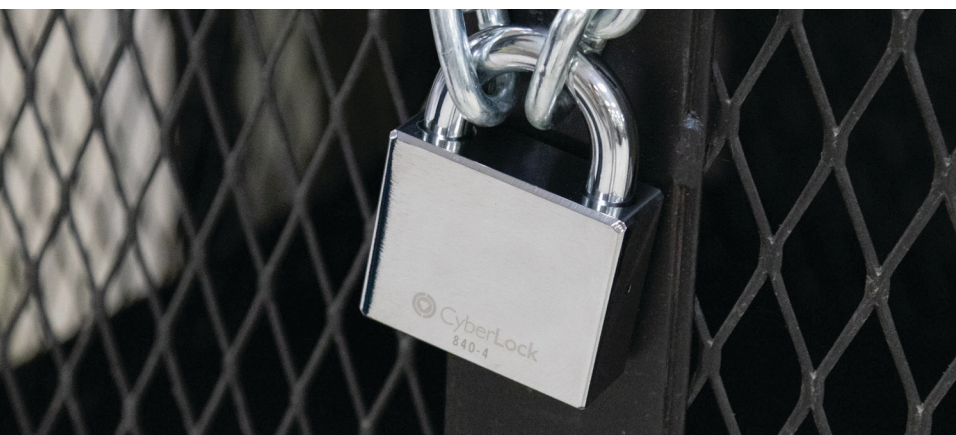

Anchor Lås Grade 5 Padlocks

Part Number: Gen 1: PLTX-01KR-DR5, PLTX-02KR-DR5
Gen 2: PLTX2-01KR-DR5, PLTX2-02KR-DR5

CyberLock is a key-centric access control system designed to increase security, accountability, and key control. Based on a unique design of electronic lock cylinders and programmable smart keys, CyberLock solves security problems that no other system can.

Quickly schedule and review access with the powerful CyberAudit-Web software. Permissions for each lock and key can be changed effortlessly, enabling precise control over access to every entry point. Email alerts and audit reports keep management informed of each person's activities, including denied access attempts.



Specifications

Physical	Chrome-plated, hardened-steel padlock body with brass and stainless steel CyberLock cylinder
Operating Temperatures	-40° to 160° F (40° to 70° C)
Weight	01KR - 44 oz (1,247 g), 02KR - 46.5 oz (1,318 g)
Power	None, power supplied by key
Compatible Keys	Compatible with all CyberKeys including Bluetooth and Wi-Fi CyberKeys; rechargeable or replaceable battery CyberKey options available.
Audit Capacity	Gen 1: Up to 1,100 open/lock events Gen 2: Up to 6,544 open/lock events
Hardware Features	Padlock body rated Grade 5 per EN12320:2012, drill-resistant CyberLock cylinder; attack-resistant torque break, tamper-resistant security features, no keyway to pick, corrosion resistance tested to Grade 5 per EN16864:2017, key retaining
Electronic Features	Delayed entry, multiple key custody, electronic rekeying

PLTX-01KR-DR5

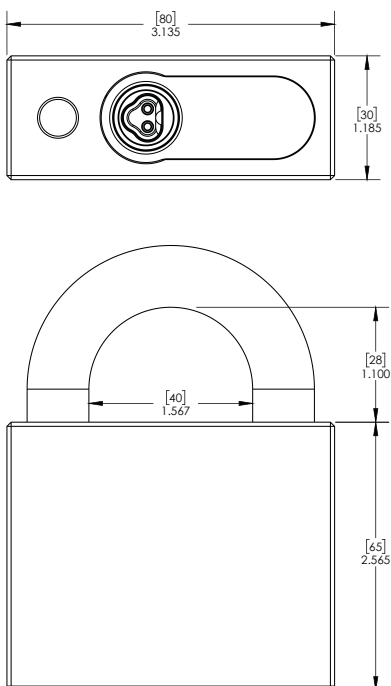

PLTX-02KR-DR5

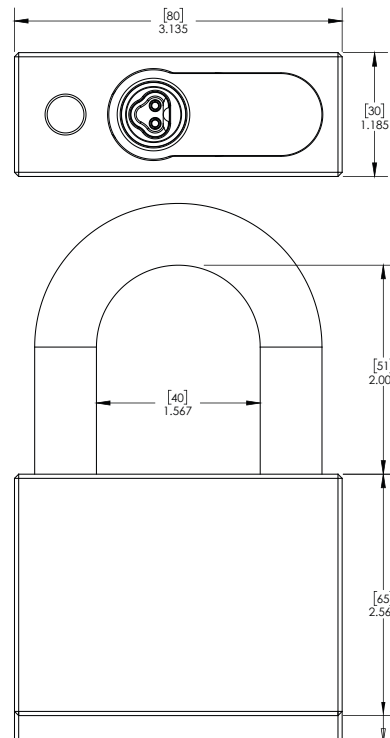

Notes:
Dimensions in inches (mm)
Drawing not to scale
Ø indicates diameter