

CyberLock Blue Padlock

CyberLock Blue padlock delivers keyless access control with the reliability and precision demanded by critical infrastructure and high-security industries. The weather-resistant, IP68-rated design can be trusted to perform in the most unforgiving environments.

BLR-PL02



Advanced Keyless Security

Bluetooth 5.0 technology and CMAC-AES256 challenge-response authentication protects important assets against unauthorized access attempts.



Real-Time Control

Issue on-demand, mobile credentials to contractors, employees and authorized visitors using the Cyber Access app. Effectively respond to emergency situations by quickly modifying a user's temporary or scheduled access from anywhere with an Internet connection.



Flexible Access Options

Select from multiple credential types to maximize the efficiency of each user. Send Cyber Access keyless credentials to Android and iOS devices via the Cyber Access app, or issue physical credentials like a FlashLock infrared fob or compatible smart key, such as the Blue 3, Air 2, or CyberKey Flash.



- CyberLock Blue padlocks have a battery life of up to 2 years, depending on usage.
- EL123 lithium battery can easily be replaced in the field.

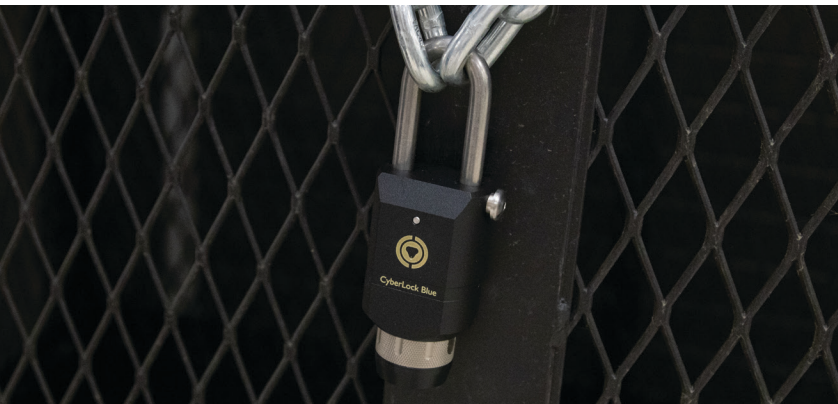

CyberLock Blue Padlock, 2" Shackle

Part Number: BLR-PL02

CAW	Version 9.6 or newer
Enterprise	<input checked="" type="checkbox"/>
Basic	<input type="checkbox"/>

CyberLock Blue is a keyless lock that facilitates access control using a Bluetooth-enabled device.



Specifications

Physical	Brass, stainless steel, and polycarbonate
Operating Temperature	-4° to 140° F (-20° to 60° C) below 14° F (-10° C) battery capacity is significantly reduced
Weight	34.8 oz (986 g)
Dimensions	6.09" L x 2.24" W x 1.5" H (154.7 mm x 56.9 mm x 38.1 mm)
Communication	Infrared, Bluetooth 5.0
Visual Output	Multicolor LED indicator light
Power	EL123 lithium battery, field replaceable
Access Options	Cyber Access app on Android or iOS, CK-FLASH, CK-AIR2, CKR-BLUE3, FK-01 IR Fob
Programming and Download Options	Cyberlink 2 on PC or Cyber Audit Link app
Software	CyberAudit® Enterprise 9.6 (or newer)
Battery Life	Up to 2 years
Audit Capacity	Up to 6,460 open/lock events
RoHS	Compliant with EU 2015/863
IP Rating	IP68

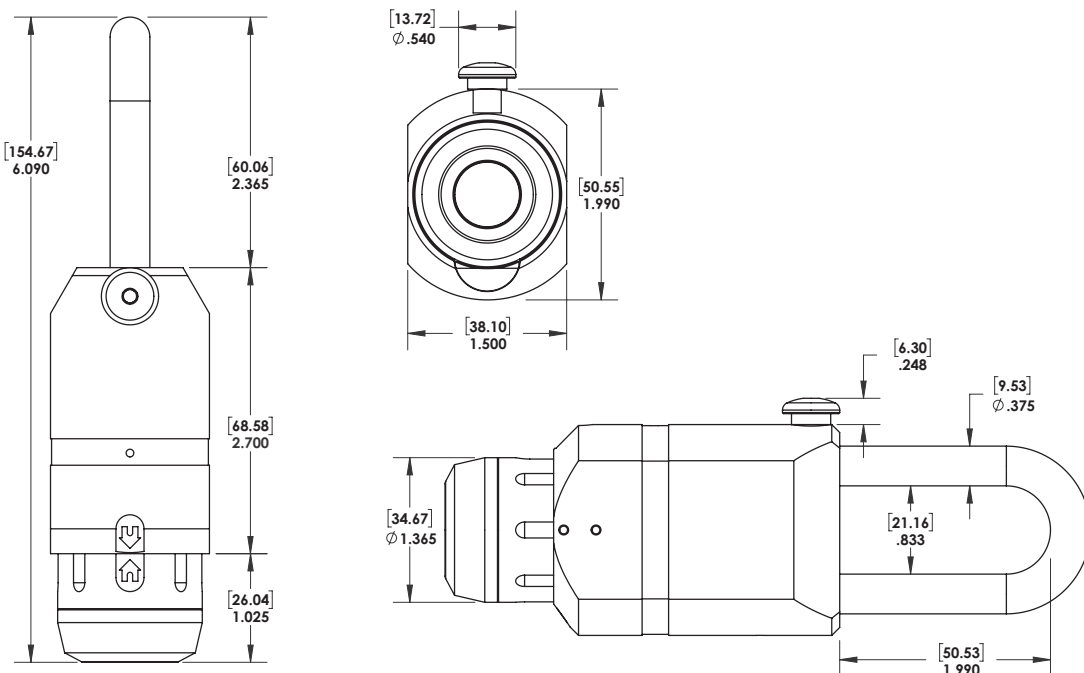

Notes:
 Dimensions in inches (mm)
 Drawing not to scale
 Ø indicates diameter