

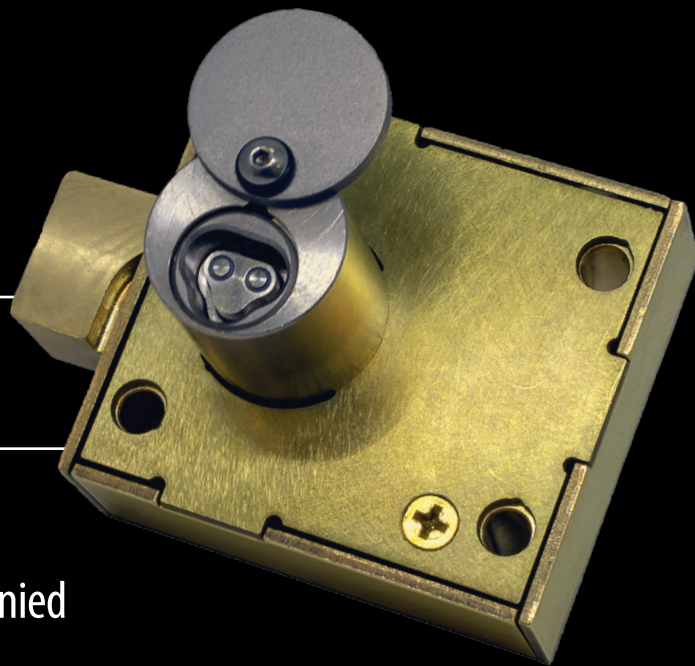

TRAFFIC CABINET LOCK

ELECTRONIC CYLINDERS RETROFIT INTO EXISTING
TRAFFIC CABINETS



» Easy Installation
» No Hardwiring or
Modification Required

» Affordable
» Audit Trails and Denied
Access Reports



Increased Accountability

Time-stamped access record in both the
lock and the key



Key Control

Eliminate the commonly used,
uncontrolled #2 mechanical key



Physical Security

Unique, sealed design negates
standard picking techniques,
IP55 rated

CyberLock is the most cost-effective way to increase accountability, eliminate tampering, and provide 24/7 security to the critical equipment contained within traffic cabinets. Unlike mechanical locks, CyberLock cylinders have no traditional keyway to pick. Once installed, cylinders resist forced rotation and are designed to remain in the locked position if tampered with.



Part Number: CL-TC2L, CL-TC2R

CyberLock is a key-centric access control system designed to increase security, accountability, and key control. Based on a unique design of electronic lock cylinders and programmable smart keys, CyberLock solves security problems that no other system can.

Traffic control administrators can quickly schedule and review access with the powerful CyberAudit-Web software. Permissions for each lock and key can be changed effortlessly, enabling precise control over access to every entry point. Email alerts and audit reports keep management informed of each person's activities, including denied access attempts.

Available in left or right hand configurations.

Specifications

Physical	Brass enclosure with nickel plated brass and stainless steel cylinder
Operating Temperature	-40° to 160° F, -40° to 70° C
Weight	11 oz (317 g)
Power	None, power supplied by key
Compatible Keys	Compatible with all CyberKeys including Bluetooth and Wi-Fi CyberKeys Rechargeable or replaceable battery CyberKey options available
Audit Capacity	Up to 1,100 open/lock events
Hardware Features	No keyway to pick, attack resistant torque break
Electronic Rekeying	Rekeying a system is done via the software; no need to install new locks and issue new keys

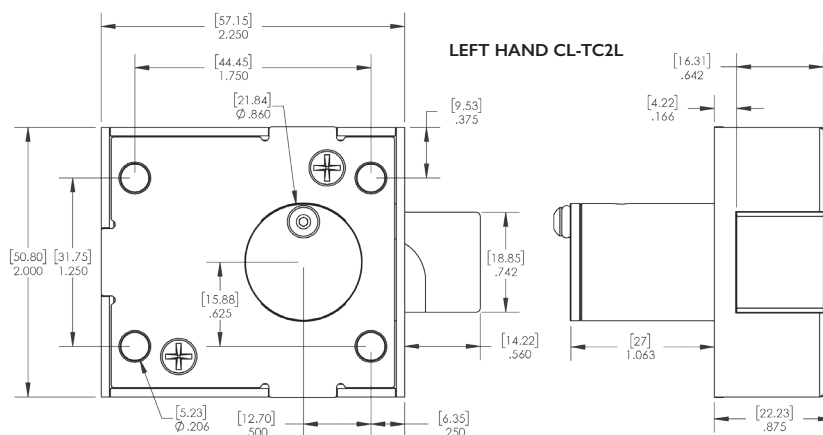
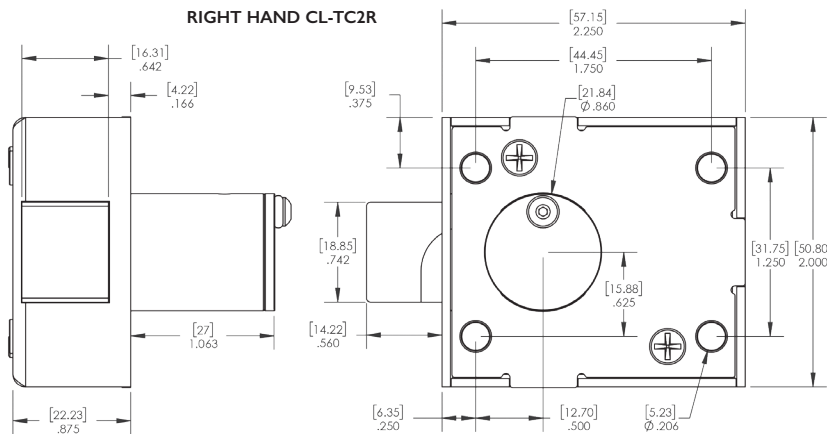
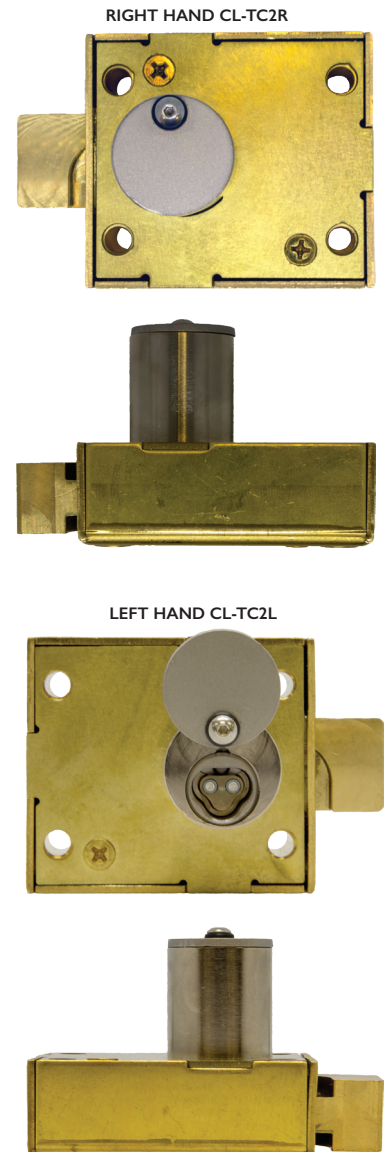

Notes:
Dimensions in inches (mm)
Drawing not to scale
Ø indicates diameter